

**Record of Map Amendments
 South Interlake Planning District By-laws
 Amending the South Interlake Planning District Development Plan
 (Adopting B/L No. 3/10)
 Map 15 – Gunton Settlement Centre**

MAP REF. #	BY-LAW NO.	COMMENTS
(1)	2/17	Replaced Map 15
(2)		
(3)		
(4)		
(5)		
(6)		
(7)		
(8)		
(9)		
(10)		
(11)		
(12)		
(13)		
(14)		
(15)		
(16)		
(17)		
(18)		
(19)		
(20)		
(21)		
(22)		
(23)		
(24)		
(25)		
(26)		
(27)		
(28)		
(29)		
(30)		
(31)		
(32)		
(33)		
(34)		
(35)		
(36)		
(37)		
(38)		
(39)		
(40)		

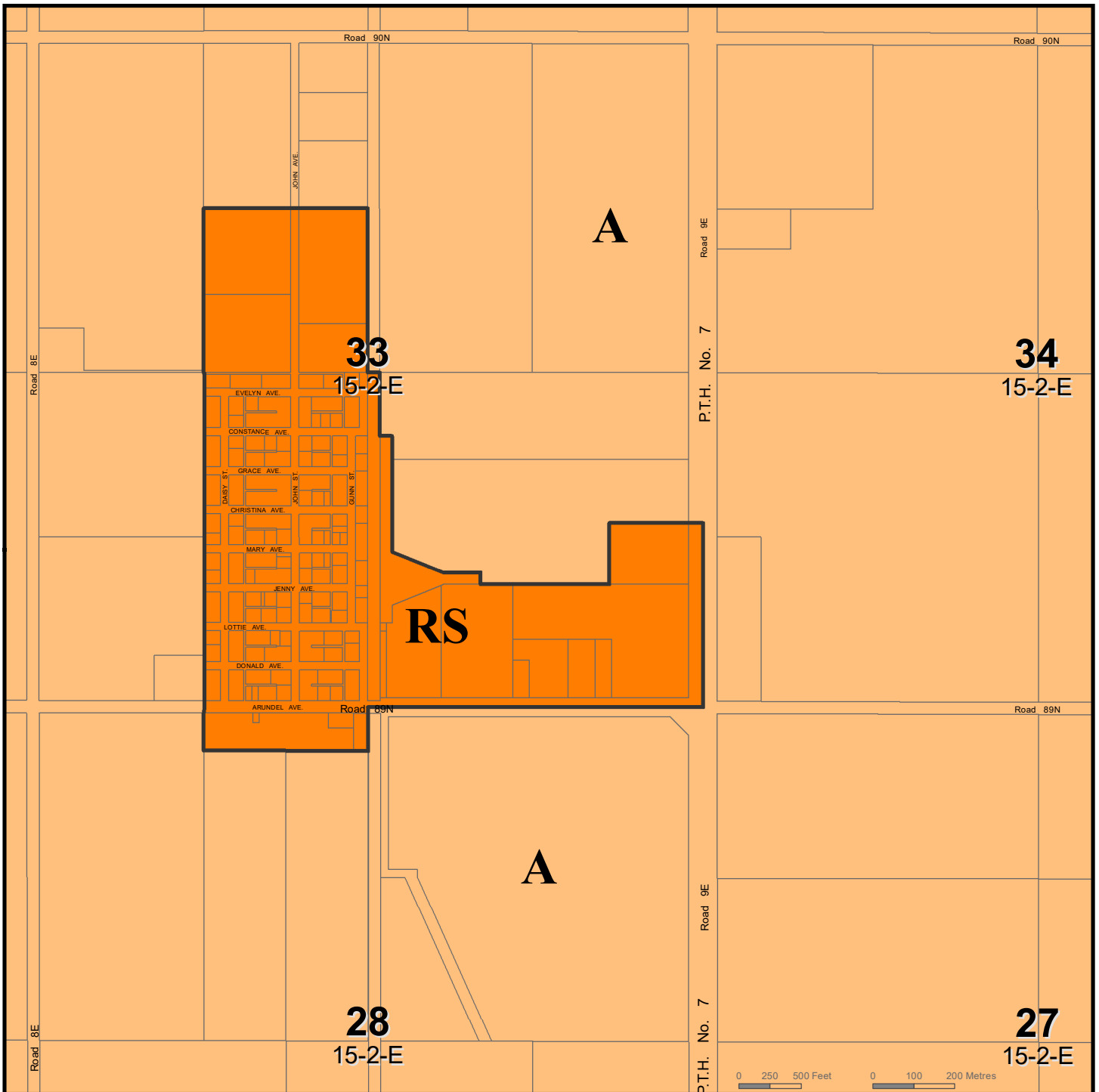

SOUTH INTERLAKE PLANNING DISTRICT DEVELOPMENT PLAN

LAND USE CLASSIFICATION

MAP 15

Gunton

OFFICE CONSOLIDATION
UP TO AND INCLUDING
BY-LAW No. 2/17
July 29, 2019

Legend:

- A Agricultural Rural Area
- RS Rural Settlement Centre