

**Record of Map Amendments  
 South Interlake Planning District By-laws  
 Amending the South Interlake Planning District Development Plan  
 (Adopting B/L No. 3/10)  
 Map 14 – Balmoral Settlement Centre**

MAP REF. #	BY-LAW NO.	COMMENTS
(1)	2/17	Replaced Map 14
(2)		
(3)		
(4)		
(5)		
(6)		
(7)		
(8)		
(9)		
(10)		
(11)		
(12)		
(13)		
(14)		
(15)		
(16)		
(17)		
(18)		
(19)		
(20)		
(21)		
(22)		
(23)		
(24)		
(25)		
(26)		
(27)		
(28)		
(29)		
(30)		
(31)		
(32)		
(33)		
(34)		
(35)		
(36)		
(37)		
(38)		
(39)		
(40)		

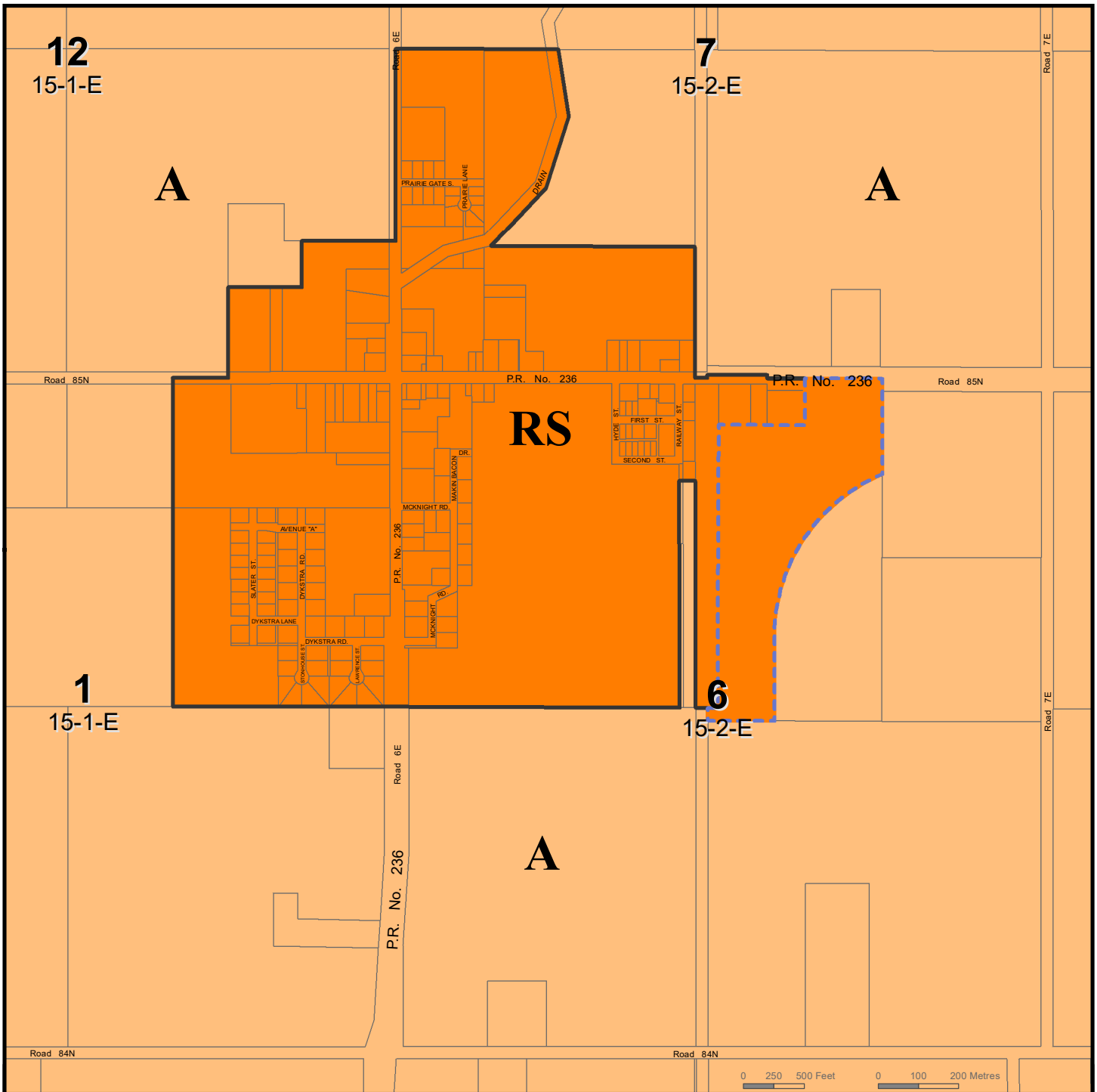

SOUTH INTERLAKE PLANNING  
DISTRICT DEVELOPMENT PLAN

**MAP 14**

**LAND USE CLASSIFICATION**

**Balmoral**

Legend:

OFFICE CONSOLIDATION  
UP TO AND INCLUDING  
BY-LAW No. 2/17  
July 29, 2019

- A** Agricultural Rural Area
- RS** Rural Settlement Centre
- Development shall be limited to non-residential